



Low Location Lighting

Expert Producer with Engineering Support



2198/13

ISO 9001

Low Location Lighting

Definition of Phosphorescent Low-Location-Lighting

- An Low Location System which uses phosphorescent material.
- Phosphorescent material contains a chemical which has the storage of strong energy when illuminated by visible light source.
- Phosphorescent material emits light which becomes visible when the ambient light source is less effective.
- The phosphorescent material gives off the visible light by stored energy for a period of time.

Requirement

- Installation of low location lighting is required to readily identify the route of escape when the normal lighting is less effective due to smoke.

By

- Emergency lighting required by regulations II -1/42 and III/11.5 of the 1974 SOLAS Convention, and
- Resolution A.752(18) adopted on November 1993, Annex
“Guidelines for Evaluation, Testing and Application of Low-Location-Lighting on passenger ships,” and
- ISO 15370 Ships and marine technology-Low Location Lighting(LLI) on passenger ships-Arrangement

Characteristics of SJ OSL Standard LLL

Type A

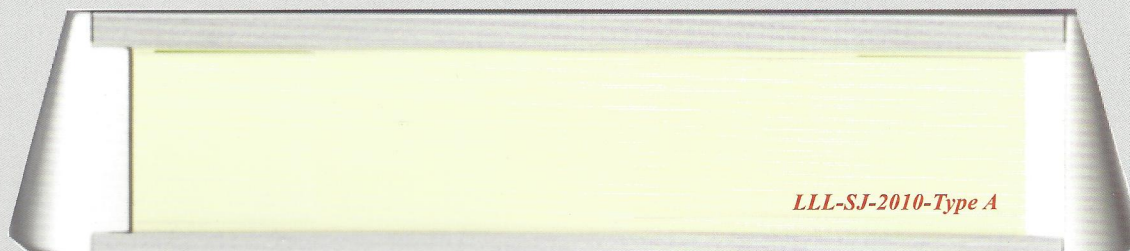

Type F

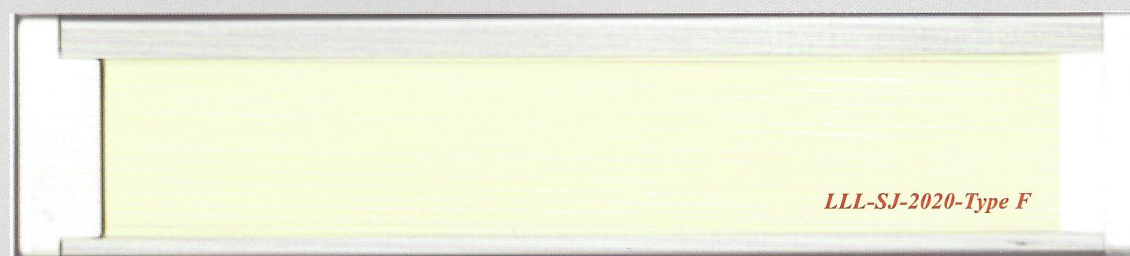

Assortment	Material (Type A & F)
Holder	Aluminum 60 Series Profile
PL Strip	Aluminum 50 Series Plate with Phosphorescent material
Holder Cap	Flame-retardant Plastic for ABS VE0812

Width	Type A	Type F
Holder	65.0 mm	70.8 mm
PL Strip	57.0 mm	57.0 mm
Luminescent	50.0 mm	50.0 mm

Luminance after Removal of Light Source (mcd/m ²)						
Assortment	10 min	20 min	30 min	40 min	50 min	60 min
Criteria	33.75					4.50
SJ Standard	57.00					13.00

SJ-2010-Type A and SJ-2020-Type F of Sun-Jin OSL Standard Low Location Lighting have been acquired the Type Approval by KR dated 26th Aug 2011, and have been acquired MED Cert by Cert No MED-MB-3008-11 dated 22nd June 2011 for ISO 15370 version 2001 and dated 30th April 2013 for ISO 15370 version 2010.

Typical Sketch for Installation

Corridor & Door, General

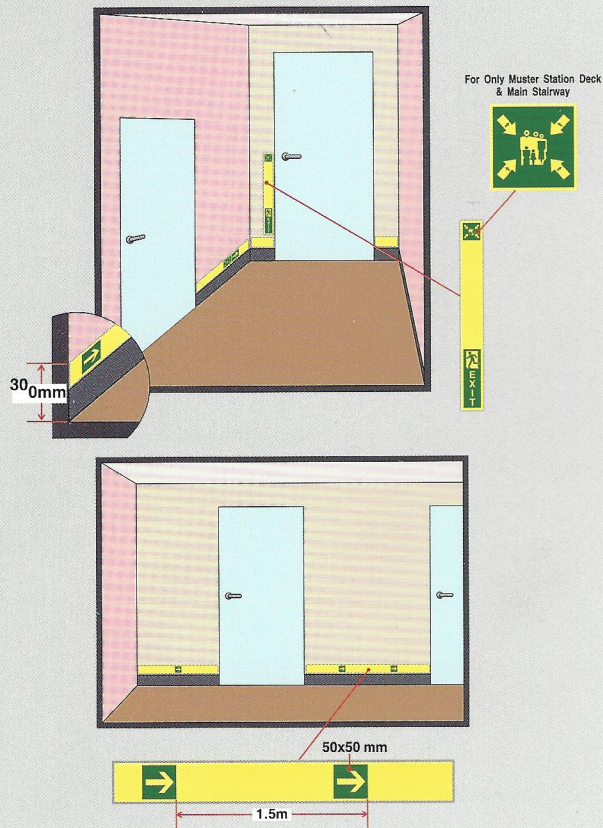

Escape Stair Way, General

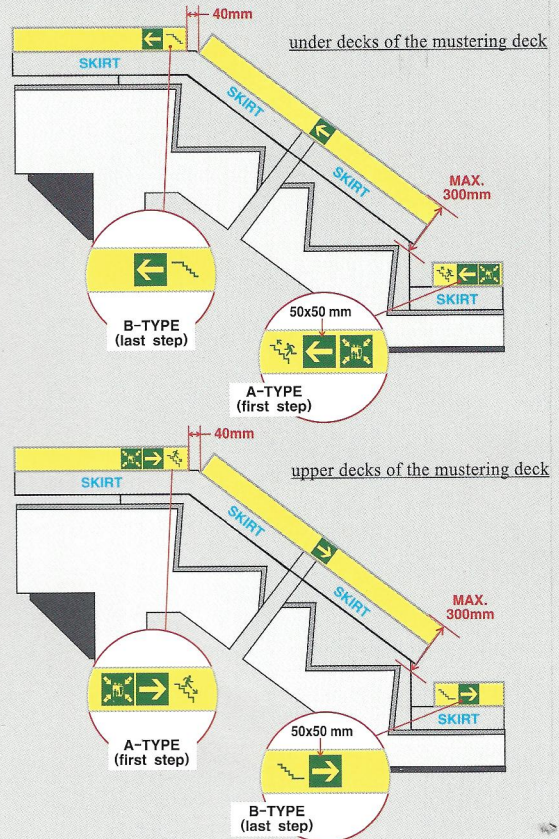

Escape Stair Way, General

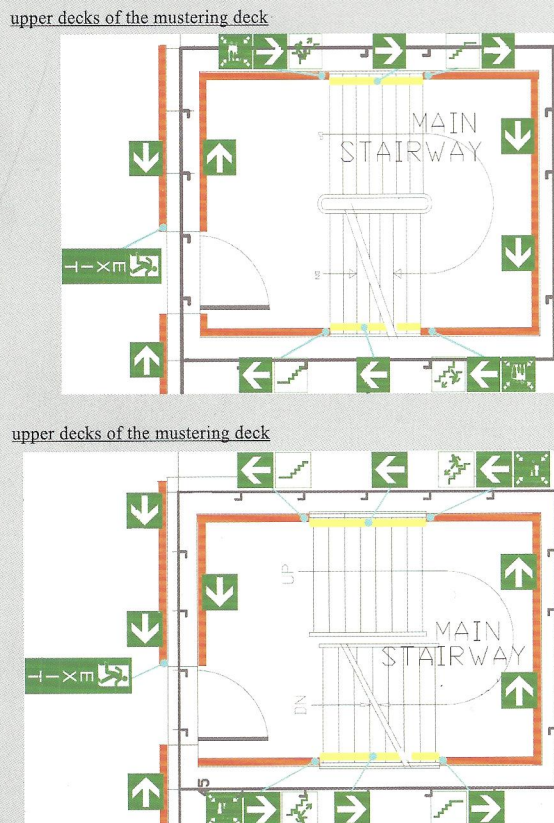

Escape Stair Way, General

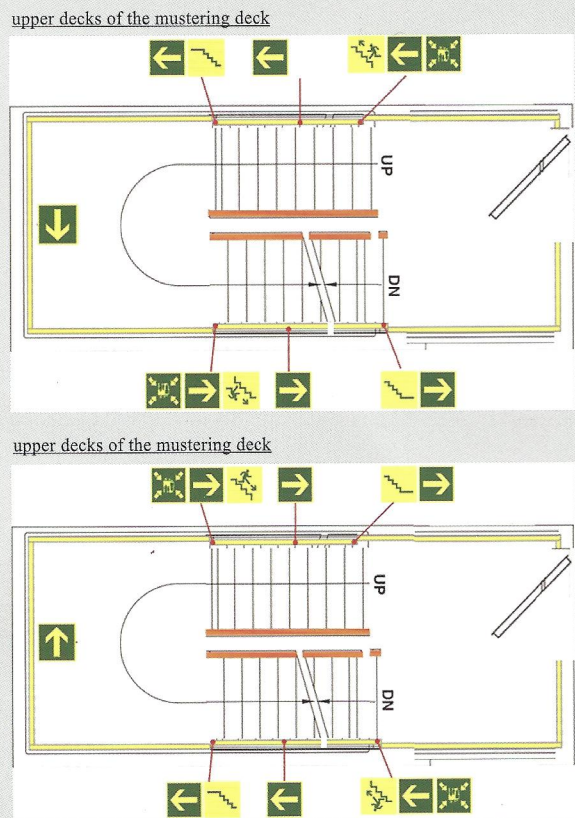

Documentary Evidence

CERTIFICATE OF APPROVAL

Korean Register of the above
with
KS Q ISO
Manuf
Locations : Head
Auditor : J. D
Subject to t
Management

KAB-QC-08
The KAB Accreditation
KR Certification Center

TYPE APPROVAL CERTIFICATE

Certificate No. : BS
Product : Lo
Manufacturer : Su
720
Product Description : Bra
Int
Se

Approval Condition : Se

THIS IS T
in accordance with the rel
standards as follows and
Equipment".
Pt.8, Ch.4 of the Rules for

This Certificate is valid un
Issued at Daejeon, Korea o

Note 1 : The approval will be auto
in the event that the exten
2 : The manufacturer should
Certificate.
AC-2A(2011.06)

KR HELLAS

Certificate No:
MED- MB-3008-11
MED Item No: A.1/3.40
This consists of 3 pages.
Page 1/3

EC TYPE EXAMINATION CERTIFICATE
as per Module B
of European Council Directive 96/98/EC on Marine Equipment (MED)

THIS IS TO CERTIFY that KR Hellas Ltd., designated by the Hellenic Republic of Greece as Notified Body according to Council Directive 96/98/EC on Marine Equipment as amended, did undertake the EC Type Examination procedures for the product identified below according to the following specific standards and that the product is found to meet the specific standards in compliance with the requirements of Annex A.1, Section 1, item No. A.1/3.40 and Annex B, Module B in the Council Directive 96/98/EC as amended by Commission Directive 2011/75/EU:

Manufacturer Name : Sun Jin O S I Co.
Address : 726-3, Mora-dong, Sasang-gu, Busan, Korea
Product Name : Low-location lighting systems (components only)
(A.1 item designation)
Product Type : SJ-LLL-Type A & SJ-LLL-Type F
Specific Standards : SOLAS 1974 as amended,
IMO Reg. II-2/13, IMO Res. MSC.98(73)-(FSS code) 11,
IMO Res. A.752(18), ISO 15370(2010)

This certificate is issued at Athens on 22nd June 2011, under the authority of the Hellenic Republic of Greece by KR Hellas Ltd., Notified Body No. 2198.

Reissued at Athens on 17th February 2014.

This certificate is valid until 21th June 2016.

Notified Body No.2198

Kwon Jae-Geun
CEO of KR Hellas Ltd.

Any person not a party to the contract pursuant which this document is delivered may not assert a claim against KKH for any liability arising out of errors or omissions which may be contained in said document, or for errors of judgment, fault or negligence committed by personnel of KKH in establishment or issuance of this document, and in connection with any activities for which it may provide. In this provision KKH shall mean the KR Hellas Ltd. as well as all its subsidiaries, directors, officers, employees and any other acting on the half of KR Hellas Ltd.

Photo View of Installed on onboard

